

NOTES:
 1. THIS DRAWING IS TO BE READ IN CONJUNCTION WITH ALL RELEVANT ARCHITECT'S AND ENGINEERS' DRAWINGS AND SPECIFICATIONS AND DBFL NOTES DRAWING No. COR-DBFL-SW-XX-DR-S-0001
 2. NO DIMENSIONS TO BE SCALED FROM THIS DRAWING. WORK TO FIGURED DIMENSIONS ONLY. REFER TO ARCHITECT'S DRAWINGS FOR SETTING OUT DIMENSIONS. DISCREPANCIES TO BE REPORTED TO ENGINEER AND ARCHITECT.

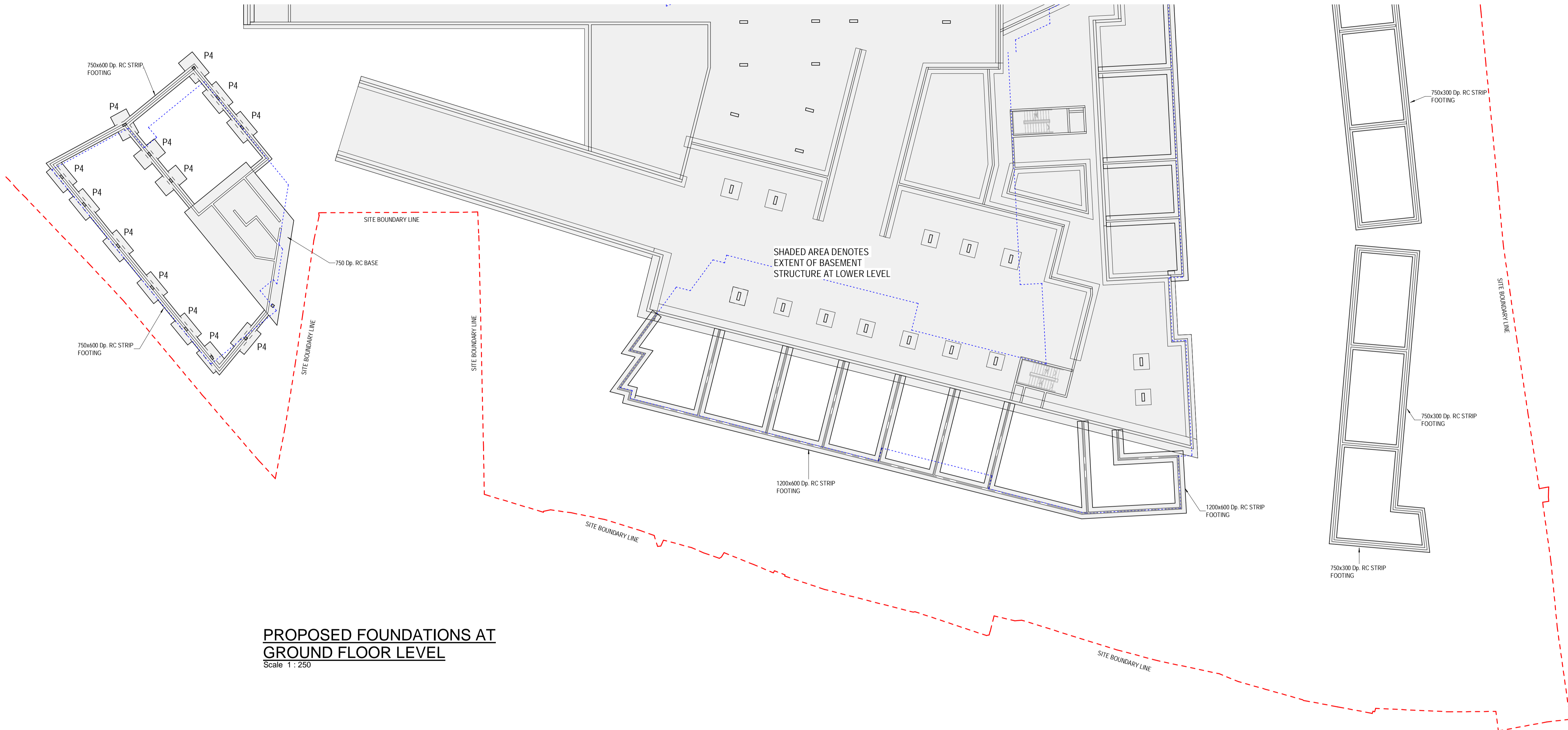

PROPOSED FOUNDATIONS AT GROUND FLOOR LEVEL
 Scale 1 : 250

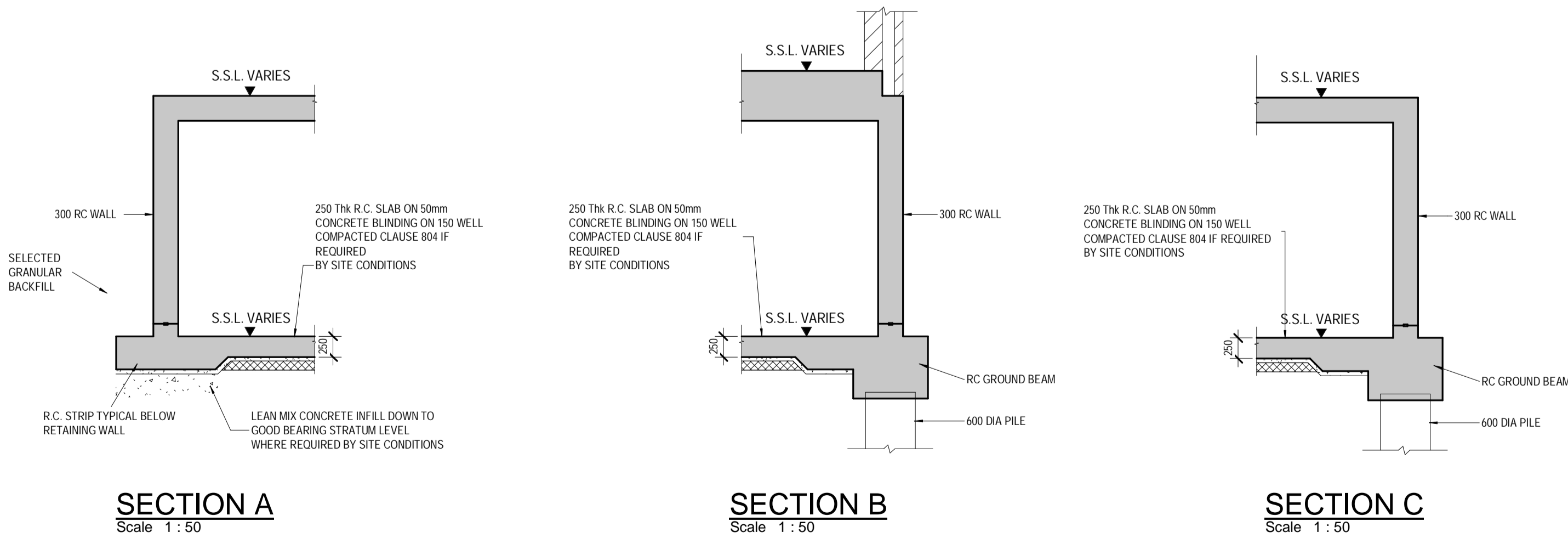

SECTION A
 Scale 1 : 50

SECTION B
 Scale 1 : 50

SECTION C
 Scale 1 : 50

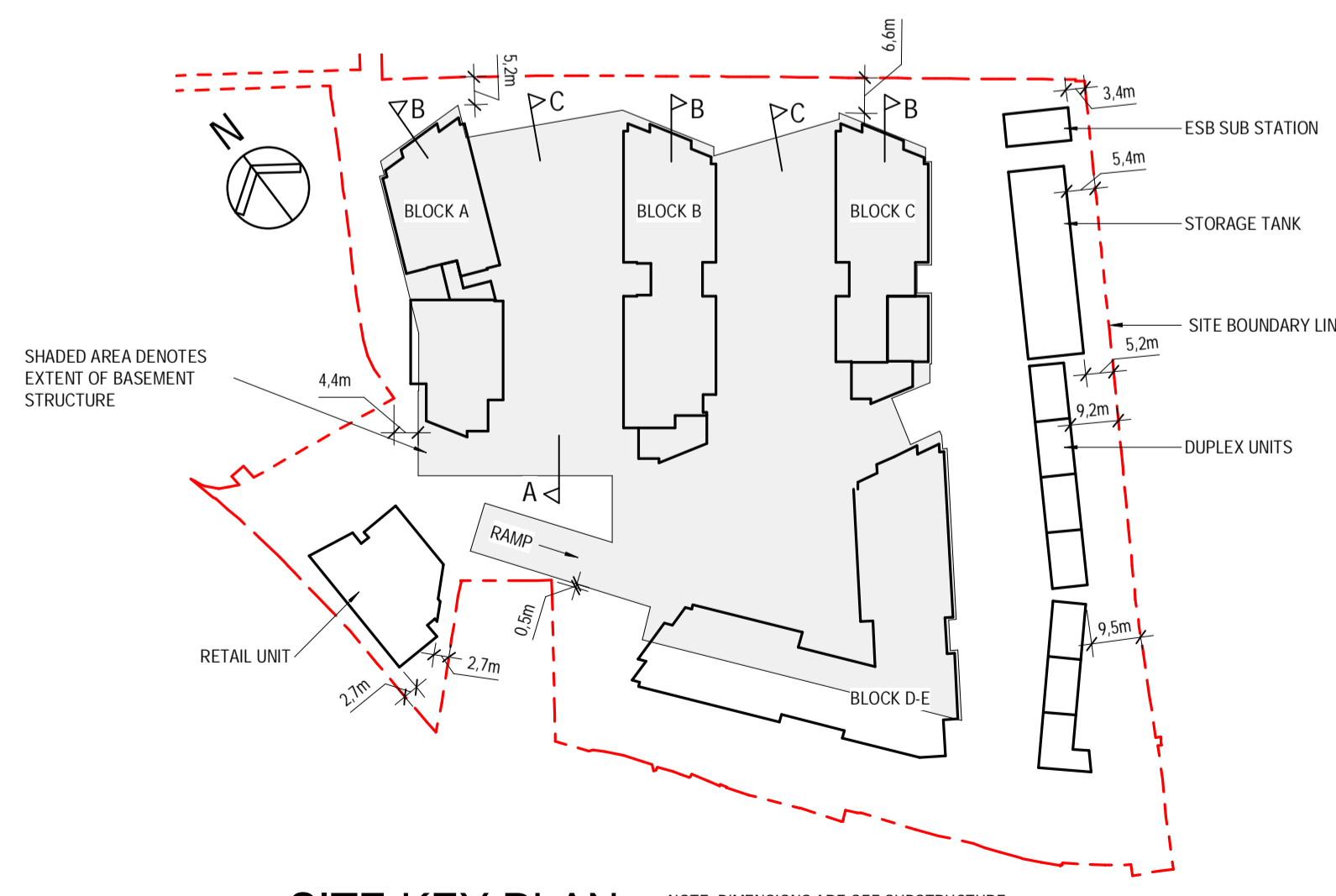

SITE KEY PLAN
 Scale 1 : 1250
 NOTE: DIMENSIONS ARE OFF SUBSTRUCTURE FOUNDATION TO BOUNDARY

PAD FOUNDATIONS		
Ref	Size	
P1	1250 x 1250 x 300 Dp.	
P2	1750 x 1750 x 400 Dp.	
P3	2000 x 2000 x 450 Dp.	
P4	3000 x 2000 x 500 Dp.	

NOTES

- ALL PILES ARE 600 DIA
- ALL PILES TO HAVE MINIMUM VERTICAL CAPACITY OF 1500KN AND HORIZONTAL CAPACITY OF 30kN
- ALL RC PILE CAPS ARE 1400mm Dp.
- ALL PERIMETER WALLS 300mm Thk.
- ALL INTERNAL BASEMENT WALLS 250mm Thk. U.N.O.
- FOR PROJECT NOTES REFER TO DRAWING No. COR-DBFL-SW-XX-DR-S-0001

MEMBER SIZES

GB1 = 1000x1200 GROUND BEAM TYPE
 GB2 = 900x900 GROUND BEAM TYPE
 GB3 = 900x750 GROUND BEAM TYPE

S1 - INFORMATION			
REV	date	description	by
P01	22/12/21	ISSUED FOR SHD APPLICATION	SW
			NW
			chkd.
client approval		A - Approved	
		B - Approved with comments	
		C - Do not use	
suitability		issue purpose	PLANNING

DBFL Consulting Engineers
 Civil, Structural & Transportation Engineering
 www.dbfl.ie

DUBLIN OFFICE Ormond House, Upper Ormond Quay, Dublin 7, Ireland.
 phone: +353 1 400 4000

WATERFORD OFFICE Unit 2, The Chandlery, 1-2 O'Connell Street, Waterford, Ireland.
 phone: +353 51 309 500

project ref: **PROPOSED DEVELOPMENT AT CORNELSCOURT**

drawing title: **PROPOSED FOUNDATIONS AT PODIUM LEVEL**

client: **CORNEL LIVING LIMITED**

designed by	author	scale	sheet size
NW	SW	As indicated	A1
drawing no.			revision
COR-DBFL-ZZ-F1-DR-S-1801			P01